

INSTALLATION AND MAINTENANCE GUIDE



ELECTRONIC LAVATORY FAUCET

stern

STERN ENGINEERING LTD.

INDEX

- | | |
|--------------|--|
| 1 | TECHNICAL DATA |
| 2-3 | PACK CONTENTS |
| 4 | PRE-INSTALLATION INFO |
| 4-9 | INSTALLATION |
| 10-12 | SETTINGS ADJUSTMENT WITH REMOTE CONTROL |
| 13 | BATTERY REPLACEMENT (BATTERY MODELS ONLY) |
| 14 | MAINTENANCE <ul style="list-style-type: none">Filters cleaning instructionsCare and cleaning of chrome and special finishes |
| 15 | SPARE PARTS LIST |
| 16 | LIMITED WARRANTY |
| 17 | TROUBLE SHOOTING |

TECHNICAL DATA

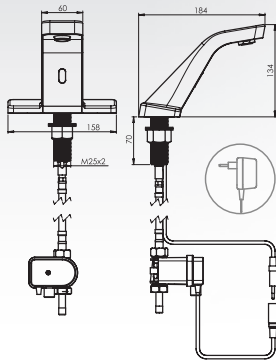

Condor 210000

Condor E 210200

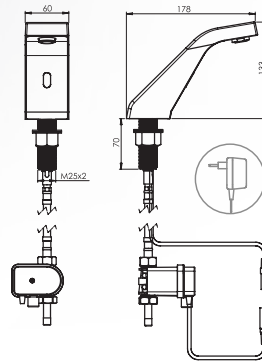

Condor 1010 210100

Condor 1010 E 210300

Power supply*:

Condor / Condor 1010: 9V alkaline battery
Condor E / Condor 1010 E: 9V transformer

Recommended water pressure:

0.5-8.0 bar (7-116 PSI)
 With water pressure of more than 8 bars,
 use a pressure reducing valve for reduction.

Preset sensor range:

180 mm Adjustable.

Minimum sensor range:

80 mm

Maximum sensor range:

300 mm

Security time:

90 seconds.

Hot water temperature:

Max 70°C

***DUAL POWER INPUT BOX OPERATION**

These models feature with a Dual power input box which in turn can be operated with a 9V battery or a 9V transformer.

In addition, the Dual power input box can serve as an integrated battery back up, for normal use during power supply failures, when a 9V battery is added (Lithium battery recommended).

PACK CONTENTS

CONDOR / CONDOR E

Familiarize yourself with the part names and confirm that the parts are included.

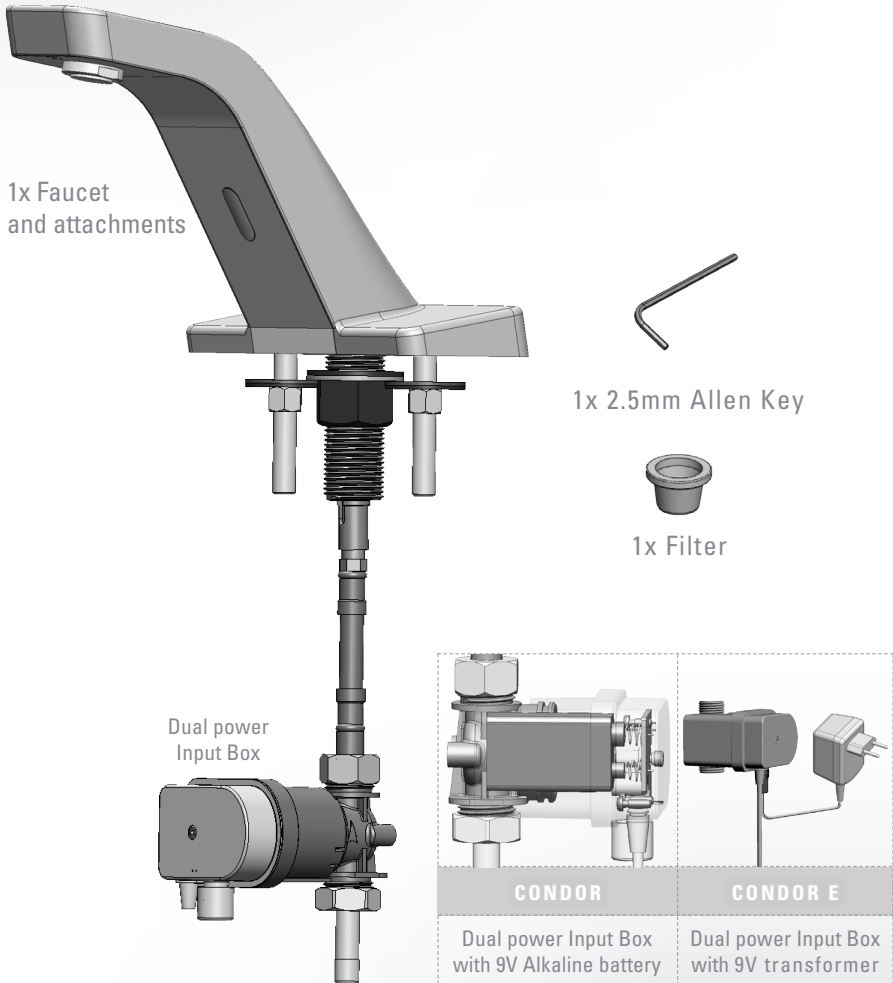

PACK CONTENTS

CONDOR 1010 / 1010 E

1x Faucet
and attachments

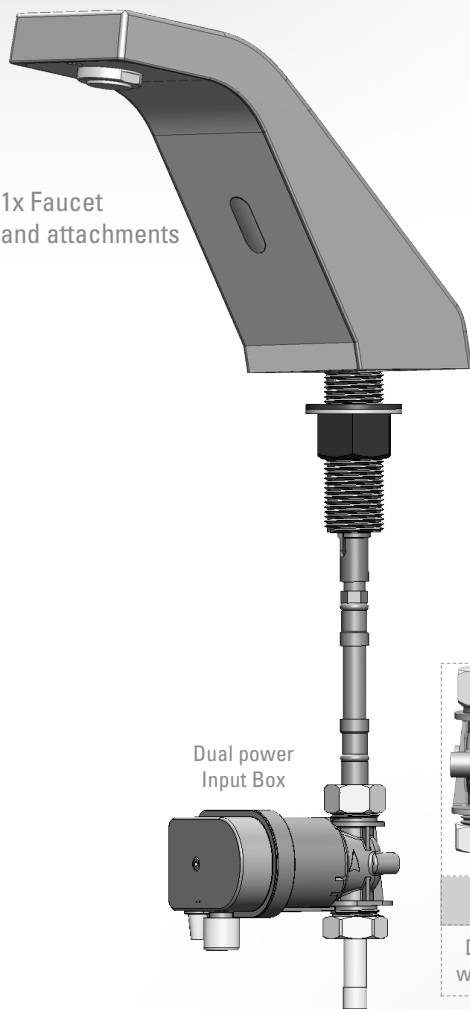

1x 2.5mm Allen Key



1x Filter

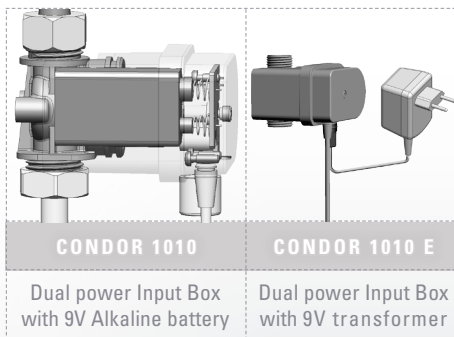

PRE-INSTALLATION INFO

Check contents

Separate all parts from the packaging and check each part with the “Pack contents” section.

Pay attention to the different models variations.

Make sure all parts are accounted for before discarding any packaging material.

If any parts are missing, do not attempt to install your electronic faucet until you obtain the missing parts.

Warnings

Do not install facing a mirror or any other electronic system operated by an infrared sensor.

To prevent reflection problems, it is recommended to keep a minimum distance of 1.50 meters between the faucet and any other objects.

Preparation for installation

Flush water supply lines thoroughly before installing the faucet. Do not allow dirt, Teflon tape or metal particles to enter the faucet.

Shut off water supply.

Important

All plumbing is to be installed in accordance with applicable codes and regulations.

FAUCET INSTALLATION

STEP 1 – PREPARATION FOR MOUNTING THE FAUCET

1

Shut off the water supply.

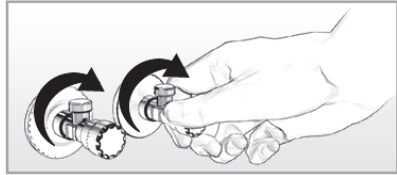

2

Disconnect the flexible hose with the nut, washer and gasket from the faucet nipple.

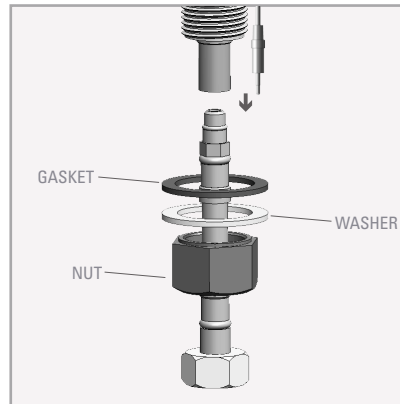

3

For Condor \ Condor E only: Remove the nut, washer and gasket from the two studs positioned on both sides of the faucet nipple.

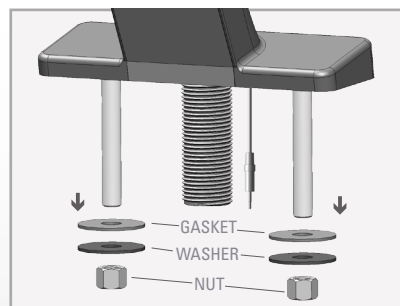

FAUCET INSTALLATION

STEP 2 – INSTALLING THE FAUCET

1

Cut a hole in the deck or lavatory.

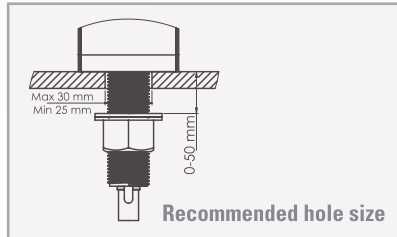

2

Pass the flexible hose along with the nut, washer and gasket through the hole in the deck or lavatory from below.

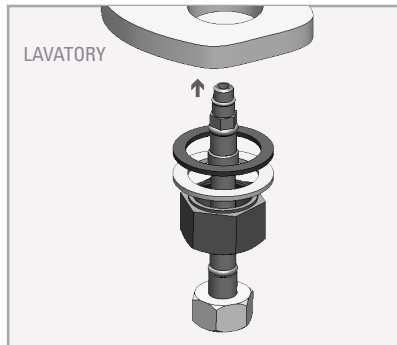

3

Connect the flexible hose to the faucet nipple.

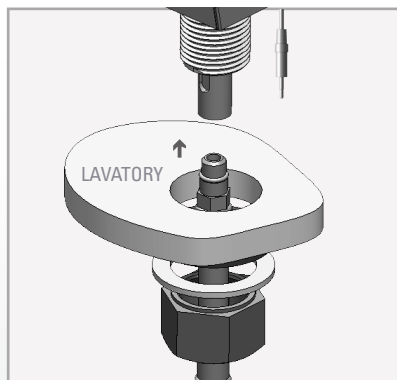

FAUCET INSTALLATION

4

For Condor \ Condor E: place the faucet body with the two studs into the holes in the deck or lavatory.

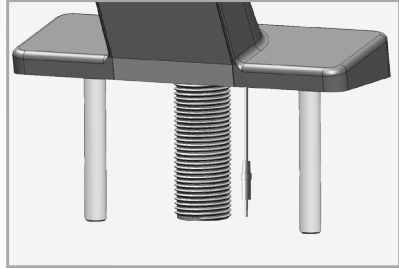

For Condor 1010 \ Condor 1010 E: place the faucet body into the hole in the deck or lavatory.

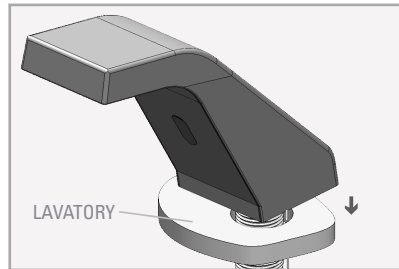

For Condor \ Condor E only: slide the disk, washer and nut over the faucet left and right studs and secure them.

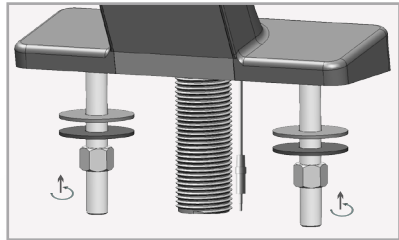

5

For all models: Slide the gasket, washer and nut over the faucet body nipple and secure it.

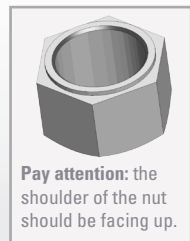
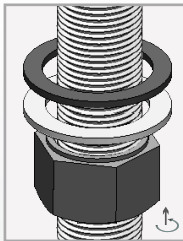

Pay attention: the shoulder of the nut should be facing up.

FAUCET INSTALLATION

STEP 3 – CONNECTING THE WATER SUPPLY

1

Connect the flexible hose coming from the faucet base to the solenoid valve housing in the dual power input box.

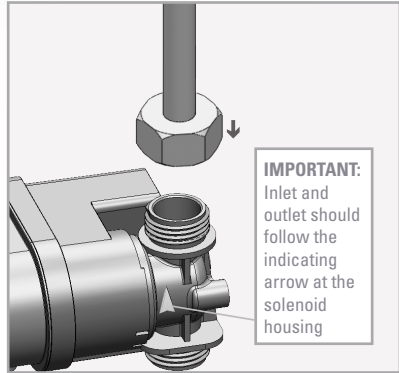

2

The faucet is provided with an inlet nipple. If needed, fit the water supply inlet to the inlet nipple at the solenoid valve housing in the dual power input box or connect it directly to the shut off valve.

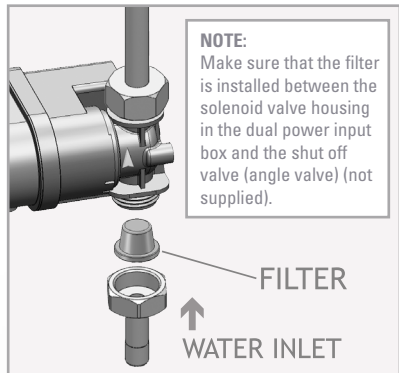

3

Turn on the central water supply and the shut-off valves (angle valves) and check for leaks.

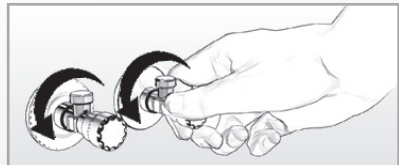

FAUCET INSTALLATION

STEP 4 – CONNECTING THE POWER SOURCE

1

Connect the 4 contacts connector coming from the faucet body to the one at the dual power input box.

Important: the 4 contacts connector should be connected properly so that the white o-ring is not visible and a clicking sound is heard.

Pay attention: If the 4 contacts connectors will not be connected properly, the motor will work continuously.

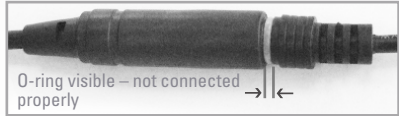

2

If your model is battery operated, open the dual power box using the Allen key provided and install the 9V Alkaline battery.

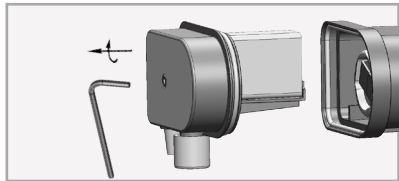

3

If your model is transformer operated, remove the IP67 rubber cap protecting the transformer socket and connect the transformer into the transformer socket. Then, plug it into the electricity socket.

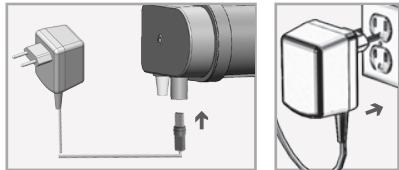

NOTE

In order to avoid entering into the adjusting mode, wait 10 seconds before you will operate the system. If the range is unsatisfactory, refer to the section titled "Settings adjustment".



This faucet includes a special aerator that allows you to adjust the water stream direction on site in order to prevent water splashing if needed. To change the angle of the water stream, simply move the adjustable tilting plate by pressing it smoothly.



SETTINGS ADJUSTMENT WITH REMOTE CONTROL



Adjusting the settings with the remote control

If necessary, the sensor settings can be adjusted as following:

Shut off the water supply. In order to adjust the sensor with the remote control, hold the remote control straight in front of the sensor in a distance of about 6-8" (15-20cm). Choose the function you want to adjust by pressing once on one of the function buttons. After pressing once on a specific function button, a quick flashing of the red light at the front of the sensor will occur. At this stage, you can change the setting by pressing the (+) or the (-) buttons, every push will increase or decrease one level. After finishing the adjustment, turn the water supply back on.

SETTINGS ADJUSTMENT WITH REMOTE CONTROL



DETECTION RANGE: The sensor range is the greatest distance that an object can be away from the sensor to activate the faucet. The sensor is factory preset.

To adjust the sensor range press + to increase detection range and – to decrease the detection range of the sensor.



SECURITY TIME: The Security time, prevents continuous flushing of water due to reflections or vandalism. By default, if the sensor is covered for more than 90 seconds the water flow will shut automatically. To resume regular operation any obstruction must be removed.

Press the SEC button. Wait until a quick flashing of the red light of the sensor eye is perceived. Then, press + to increase the security time and – to reduce it.



DELAY IN TIME: It is recommended to change the delay in time for flush valves for urinals or toilets only.

If required, the delay in time can be modified also in faucets as follows: Press the IN button. Wait until a quick flashing of the red light of the sensor eye is perceived. Then, press + to increase the delay in time and – to reduce it.



DELAY OUT TIME: This button allows modifying the water flow time after the user removes his hands from the faucet. A delay out time close to 0 will save more water. An increased delay out time will make the user experience more comfortable.

If required, the delay out time can be modified as follows: Press the OUT button. Wait until a quick flashing of the red light of the sensor eye is perceived. Then, press + to increase the delay out time and – to reduce it.



24 HOUR HYGIENE FLUSH: If you have a compatible model with a 24 hours hygiene flush it is possible to enable and disable it.

To activate the hygiene flush, press the clock button. Wait until a quick flashing of the red light of the sensor eye is perceived. Then press + to activate the hygiene flush or – to deactivate it.

SETTINGS ADJUSTMENT WITH REMOTE CONTROL



LOCK OUT TIME: It is possible to program a lock out time in Stern products upon request. This lock out time allows a user to activate the faucet, only after a specific amount of time has passed.

If a specific lock out time was preset in a Stern product as default, and you would like to deactivate it, press the lock button. Wait until a quick flashing of the red light of the sensor eye is perceived. Then press + to activate the lock out time or – to deactivate it.

To activate it again, press the lock button and without releasing it, press the + button once.



TEMPORARY OFF FUNCTION: This function is ideal to perform any kind of activity in front of the sensor without operating the system (for example, cleaning).

Faucets will remain shut for 1 minute when this button is pressed once. To cancel this function and to return to normal operation press the On/Off button again or wait 1 minute.



RESET BUTTON: This function allows the sensor to return to the original factory preset settings.

If required, press the Reset button and without releasing it, press the + button once.

BATTERY REPLACEMENT

Battery models only (Condor \ Condor 1010)

When the battery weakens, the red indicator light will blink at a constant rate when the user's hands are within the sensor range. The battery must be replaced within two weeks.

To replace the battery at Condor \ Condor 1010:

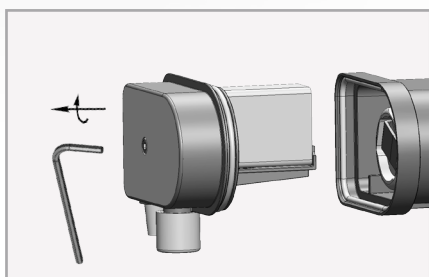

- 1** Carefully open the dual power input box using the 2.5mm Allen key provided.

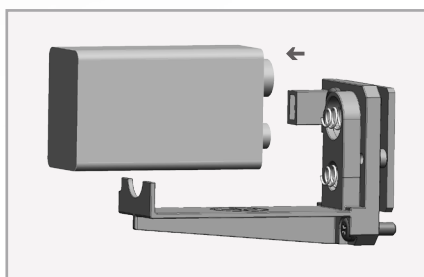

- 2** Remove the old battery.

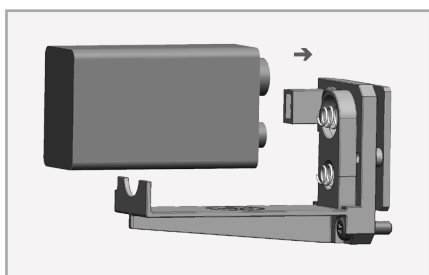

- 3** Replace the used battery with a new 9V battery (Lithium battery is recommended).

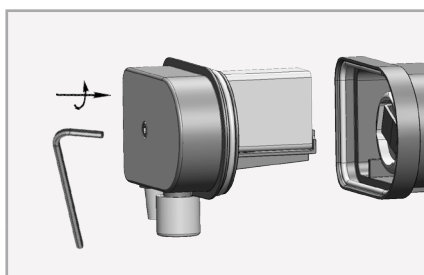

- 4** Close the box

Important: Spent batteries should not be disposed of with normal household waste. Contact your local authority for information on waste disposal and recycling.



MAINTENANCE

Filter cleaning instructions

This faucet is provided with one / two stainless steel filter(s) preventing foreign particles to enter the lines. If the water flow has decreased, this can be because the filter(s) is/are clogged. The filter(s) can be cleaned as follows:

1. Shut-off the water shut off valve (angle valve).
2. Disconnect the flexible pipe/s.
3. Remove the filter(s) and wash it/them under running water.
4. Reassemble the parts.
5. Make sure that there is no water leakage.

Care and cleaning of chrome and special finishes

DO NOT use steel wool or cleansing agents containing alcohol, acid, abrasives, or the like. Use of any prohibited cleaning or maintenance products or substances could damage the surface of the faucet. For surface cleaning of faucet use **ONLY** soap and water, then wipe dry with clean cloth or towel. When cleaning bathroom tile, the faucets should be protected from any splattering of harsh cleansers.

SPARE PARTS LIST

Condor

Seals and Screws Kit	Cat. No. 07210103
Sensor Kit	Cat. No. 07220153
Solenoid Housing Dual Power Kit	Cat. No. 07231011
Solenoid Housing Dual Power Kit USA	Cat. No. 07231012
Solenoid Valve Kit	Cat. No. 07230018
Dual Power Cover Kit	Cat. No. 07220080
Transformer	Cat. No. 06522047

Condor 1010

Seals and Screws Kit	Cat. No. 07210105
Sensor Kit	Cat. No. 07220153
Solenoid Housing Dual Power Kit	Cat. No. 07231011
Solenoid Housing Dual Power Kit USA	Cat. No. 07231012
Solenoid Valve Kit	Cat. No. 07230018
Dual Power Cover Kit	Cat. No. 07220080
Transformer	Cat. No. 06522047

LIMITED WARRANTY

Y. Stern Engineering Ltd. warrants that its electronic faucets, flush valves and controls will be free of defects in material and workmanship during normal use for two years from the date the product is purchased.

If a defect is found in normal use, Y. Stern Engineering Ltd. will, at its discretion, repair, provide a replacement part or product, or make appropriate adjustments. Damage caused by accident, misuse, or abuse is not covered by this warranty. Improper care and cleaning will void the warranty. Proof of purchase (original sales receipt) must be provided to Stern Engineering Ltd. with all warranty claims.

Stern Engineering Ltd is not responsible for labor charges, installation, or other incidental or consequential costs other than those noted above. In no event shall the liability of Stern Engineering Ltd. exceed the purchase price of the faucet, valve or control.

If you believe that you have a warranty claim, contact your Stern Distributor, Dealer or Plumbing Contractor. Please be sure to provide all pertinent information regarding your claim, including a complete description of the problem, the product, model number, the date the product was purchased, from whom the product was purchased and the installation date. Also include your original invoice.

Y. STERN ENGINEERING AND/OR SELLER DISCLAIM ANY LIABILITY FOR SPECIAL, INCIDENTAL OR CONSEQUENTIAL DAMAGES. This warranty excludes product damage due to installation error, incorrect maintenance, wear and tear, battery, water composition, product abuse, or product misuse, whether performed by a contractor, service company, or the consumer. This warranty does not cover product damage caused by the following:

- Incorrect installation, inversions of supply pipes.
- Pressures or temperatures exceeding recommended limits.
- Improper manipulation, tampering, bad or lapsed maintenance.
- Foreign bodies, dirt or scale introduced by the water supply.

TROUBLE SHOOTING

PROBLEM	INDICATOR	CAUSE	SOLUTION	
No water coming out of the faucet:	1. Sensor flashes continuously when user's hands are within the sensor's range.	Low battery	Replace battery	
	2. Red light in the sensor does not flash once when user's hands are within the sensor's range.	1. Range is too short.	Increase the range.	
		2. Range is too long.	Decrease the range.	
		3. Battery is completely used up	The battery must be replaced.	
		4. Unit is in "Security Mode"*		
		5. Sensor is picking up reflections from the washbasin or another object.	Eliminate cause of reflection.	
	3. Red light in the sensor flashes once when user's hands are within the sensor's range.	6. Connectors between the electronic unit and the Dual power input box are disconnected or not connected all the way through.	Connect the connectors all the way through. Refer to page 10 to see how.	
			1. Debris or scale in solenoid.	Unscrew solenoid, pull out the plunger and the spring from the solenoid and clean them. Use scale remover material if needed. When replacing the plunger, please make sure that the spring is in vertical position.
			2. The central orifice in the diaphragm is plugged or the diaphragm is torn	Clean the orifice or replace diaphragm.
			3. The water supply pressure is higher than 8 bar.	Reduce the supply water pressure.
Water flow from spout does not stop:	4. The water supply pressure is under 8 bars and yet the pressure in the faucet's body is higher. This situation could be caused by a sudden increase in the water supply pressure that the backcheck prevents from dropping, even after water supply pressure drops under 8 bars.	Shut off water supply and unscrew one of the flexible pipes in order to reduce the pressure that blocks the product.		
		1. Sensor flashes once when user's hands are within the sensor's range	1. Debris or scale in diaphragm	Clean the orifice or replace diaphragm.
		2. Red light in the sensor does not flash once when user's hands are within the sensor's range.	2. Connectors between the electronic unit and the Dual power input box are not connected all the way through	Connect the connectors all the way through. Refer to page 10 to see how.
			1. Sensor is dirty or covered.**	Clean or eliminate cause of interference.
		2. Sensor is picking up reflections from the washbasin or another object.	1. Decrease the range or eliminate cause of reflection.	
		Water flow diminished	Filter or aerator is clogged	Remove, clean, re-install

* "Security Mode": If the sensor is covered for more than 90 sec. the faucet will automatically shut off water flow. To return to normal operation remove any blockage.

** In this case, the water flow will stop anyway after 90 seconds because of the security time.

STERN

STERN ENGINEERING LTD.

15 Gan Rave Blvd., 81222 Gan Rave, Yavne, Israel

Tel: 972-8-9326000, Fax: 972-8-9326025, export@sternfaucets.com

www.sternfaucets.com



01.16 01500088-C